

SUWANNEE VALLEY ESTATES

A SUBDIVISION IN SECTION 31, TOWNSHIP 4 SOUTH, RANGE 14 EAST, SUWANNEE COUNTY, FLORIDA



LOT	AREA	PERMANENT EASEMENTS	RESERVATIONS
1	6,467.25		
2	6,467.25		
3	19,827.26		
4	6,467.25		
5	19,827.26		
6	6,467.25		
7	6,467.25		
8	6,467.25		
9	6,467.25		
10	6,467.25		
11	6,467.25		
12	6,467.25		
13	6,467.25		
14	6,467.25		
15	6,467.25		
16	6,467.25		
17	6,467.25		
18	6,467.25		
19	6,467.25		
20	6,467.25		
21	6,467.25		
22	6,467.25		
23	6,467.25		
24	6,467.25		
25	6,467.25		
26	6,467.25		
27	6,467.25		
28	6,467.25		
29	6,467.25		
30	6,467.25		
31	6,467.25		
32	6,467.25		
33	6,467.25		
34	6,467.25		
35	6,467.25		
36	6,467.25		

GRAPHIC SCALE: 1"=200'

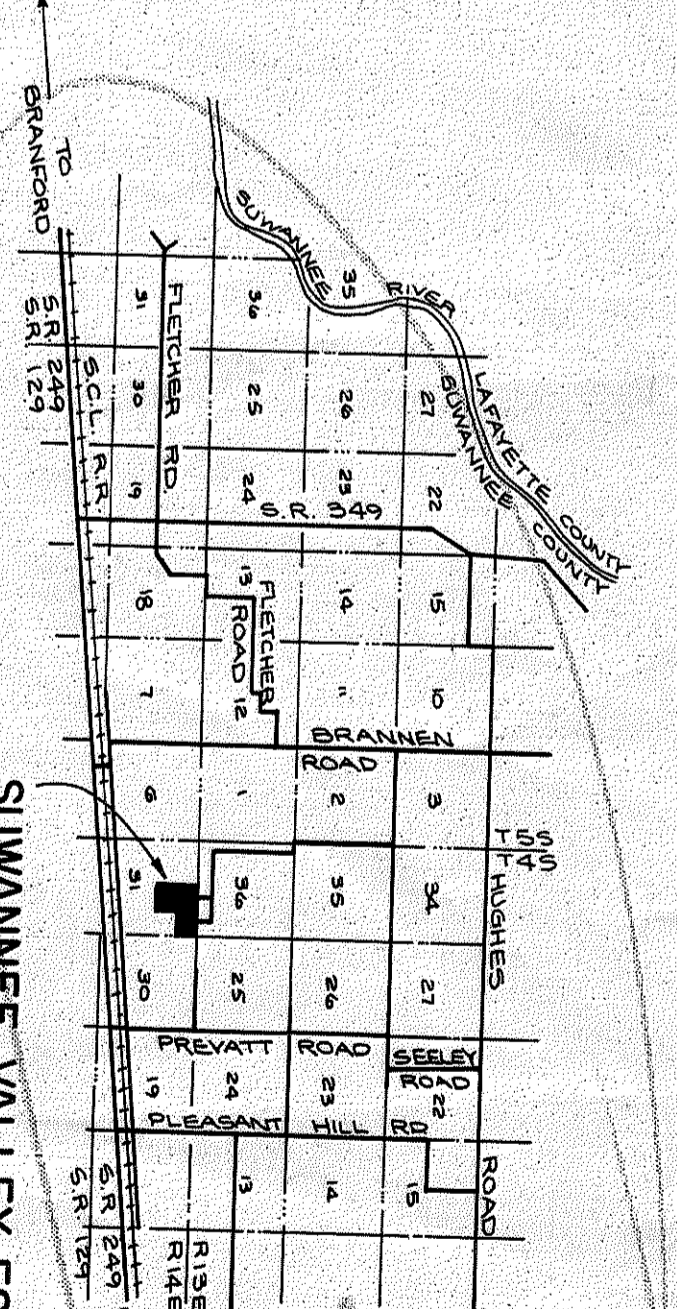
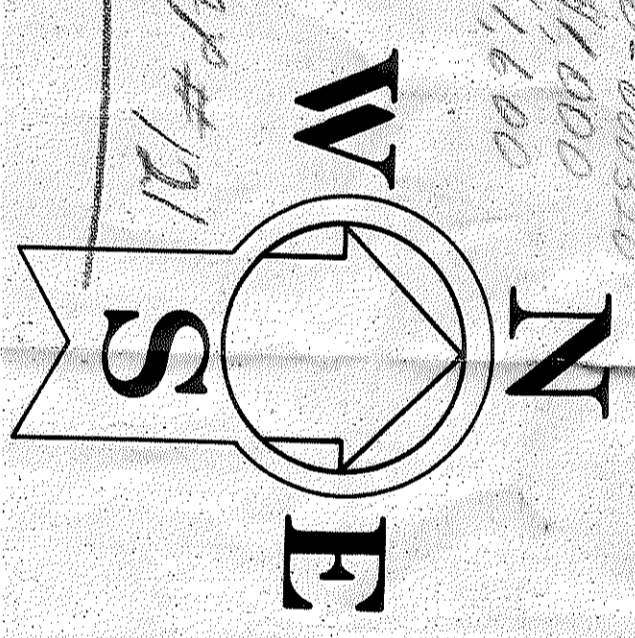

SUWANNEE VALLEY ESTATES

LEGAL DESCRIPTION
 PARCEL A, THE 1/2 OF THE NW 1/4 AND THE 1/2 OF THE SE 1/4 OF SECTION 31, TOWNSHIP 4 SOUTH, RANGE 14 EAST, SUWANNEE COUNTY, FLORIDA. THE 1/2 OF THE NW 1/4 OF SECTION 31, TOWNSHIP 4 SOUTH, RANGE 14 EAST, SUWANNEE COUNTY, FLORIDA. THE 1/2 OF THE SE 1/4 OF SECTION 31, TOWNSHIP 4 SOUTH, RANGE 14 EAST, SUWANNEE COUNTY, FLORIDA. THE 1/2 OF THE NW 1/4 OF SECTION 31, TOWNSHIP 4 SOUTH, RANGE 14 EAST, SUWANNEE COUNTY, FLORIDA. THE 1/2 OF THE SE 1/4 OF SECTION 31, TOWNSHIP 4 SOUTH, RANGE 14 EAST, SUWANNEE COUNTY, FLORIDA.

ACKNOWLEDGEMENT
 STATE OF FLORIDA, COUNTY OF SUWANNEE
 I, the undersigned, Clerk of the County of Suwannee, Florida, do hereby certify that the foregoing instrument was duly recorded in the Public Records of the County of Suwannee, Florida, on this 30 day of June, AD 1982, by CARIDAD E. LEE, Notary Public, State of Florida.

ACKNOWLEDGEMENT
 STATE OF FLORIDA, COUNTY OF SUWANNEE
 I, the undersigned, Clerk of the County of Suwannee, Florida, do hereby certify that the foregoing instrument was duly recorded in the Public Records of the County of Suwannee, Florida, on this 30 day of June, AD 1982, by CARIDAD E. LEE, Notary Public, State of Florida.

ACKNOWLEDGEMENT
 STATE OF FLORIDA, COUNTY OF SUWANNEE
 I, the undersigned, Clerk of the County of Suwannee, Florida, do hereby certify that the foregoing instrument was duly recorded in the Public Records of the County of Suwannee, Florida, on this 30 day of June, AD 1982, by CARIDAD E. LEE, Notary Public, State of Florida.

ACKNOWLEDGEMENT
 STATE OF FLORIDA, COUNTY OF SUWANNEE
 I, the undersigned, Clerk of the County of Suwannee, Florida, do hereby certify that the foregoing instrument was duly recorded in the Public Records of the County of Suwannee, Florida, on this 30 day of June, AD 1982, by CARIDAD E. LEE, Notary Public, State of Florida.

ACKNOWLEDGEMENT
 STATE OF FLORIDA, COUNTY OF SUWANNEE
 I, the undersigned, Clerk of the County of Suwannee, Florida, do hereby certify that the foregoing instrument was duly recorded in the Public Records of the County of Suwannee, Florida, on this 30 day of June, AD 1982, by CARIDAD E. LEE, Notary Public, State of Florida.