

J.P.R. WALK

SITUATED IN: PART OF THE NORTHWEST 1/4 OF SECTION 10, TOWNSHIP 4 SOUTH, RANGE 11 EAST AND PART OF THE SOUTHWEST 1/4 OF THE NORTHWEST 1/4 OF SECTION 2, TOWNSHIP 4 SOUTH, RANGE 11 EAST, SUWANNEE COUNTY, FLORIDA.

BLOCK 1
PART OF THE NORTHEAST 1/4 OF SECTION 10, TOWNSHIP 4 SOUTH, RANGE 11 EAST, SUWANNEE COUNTY, FLORIDA, BEING MORE PARTICULARLY DESCRIBED AS FOLLOWS: FOR POINT OF BEGINNING COMMENCE AT THE NORTHWEST CORNER OF SAID NORTH 1/2 OF THE NORTHWEST 1/4 OF SECTION 10, A DISTANCE OF 1275.76 FEET TO THE WEST RIGHT-OF-WAY LINE OF AN EXISTING COUNTY ROAD (LURAVILLE ROAD); THENCE RUN SOUTH 01°16'58" EAST ALONG SAID WEST RIGHT-OF-WAY LINE A DISTANCE OF 1324.76 FEET TO THE SOUTH LINE OF SAID NORTHWEST 1/4 OF SECTION 10, A DISTANCE OF 1284.94 FEET TO THE SOUTHWEST CORNER OF SAID NORTHWEST 1/4 OF SECTION 10, A DISTANCE OF 1328.20 FEET TO THE POINT OF BEGINNING.

BLOCK 2
PART OF THE NORTH 1/2 OF SECTION 10, TOWNSHIP 4 SOUTH, RANGE 11 EAST, SUWANNEE COUNTY, FLORIDA, BEING MORE PARTICULARLY DESCRIBED AS FOLLOWS: FOR POINT OF BEGINNING COMMENCE AT THE SOUTHWEST CORNER OF SAID NORTH 1/2 OF THE NORTHWEST 1/4 OF SECTION 10, A DISTANCE OF 2693.66 FEET TO THE EAST RIGHT-OF-WAY LINE OF AN EXISTING COUNTY ROAD (LURAVILLE ROAD); THENCE RUN NORTH 01°16'58" WEST ALONG SAID EAST RIGHT-OF-WAY LINE A DISTANCE OF 907.31 FEET; THENCE RUN NORTH 89°03'51" EAST, A DISTANCE OF 195.87 FEET; THENCE RUN NORTH 00°53'37" WEST, A DISTANCE OF 872.42 FEET TO THE SOUTH RIGHT-OF-WAY LINE OF AN EXISTING COUNTY ROAD (NEW HARMONY ROAD); THENCE RUN NORTH 89°03'51" EAST ALONG SAID SOUTH RIGHT-OF-WAY LINE A DISTANCE OF 2442.00 FEET TO THE EAST LINE OF SAID SECTION 10, THENCE RUN SOUTH 00°54'07" EAST ALONG SAID EAST LINE A DISTANCE OF 1293.75 FEET TO THE POINT OF BEGINNING.

BLOCK 3
PART OF THE SOUTHWEST 1/4 OF SECTION 2, TOWNSHIP 4 SOUTH, RANGE 11 EAST SUWANNEE COUNTY, FLORIDA, BEING MORE PARTICULARLY DESCRIBED AS FOLLOWS: FOR POINT OF REFERENCE COMMENCE AT THE SOUTHWEST CORNER OF SAID SOUTHWEST 1/4 OF SECTION 2, THENCE RUN NORTH 00°59'59" WEST ALONG THE WEST LINE OF SAID SOUTHWEST 1/4 OF SECTION 2, A DISTANCE OF 30.00 FEET TO THE NORTH RIGHT-OF-WAY LINE OF AN EXISTING COUNTY ROAD (NEW HARMONY ROAD); THENCE RUN NORTH 88°54'07" WEST ALONG SAID NORTH RIGHT-OF-WAY LINE A DISTANCE OF 1270.47 FEET; THENCE RUN NORTH 00°57'14" WEST, A DISTANCE OF 1028.95 FEET; THENCE RUN NORTH 88°54'07" EAST, A DISTANCE OF 1269.62 FEET; THENCE RUN SOUTH 00°59'59" EAST, A DISTANCE OF 1028.95 FEET TO THE POINT OF BEGINNING.

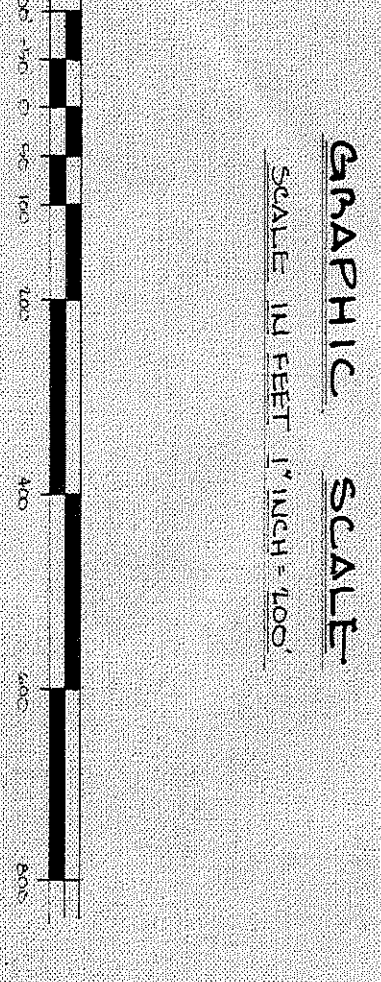
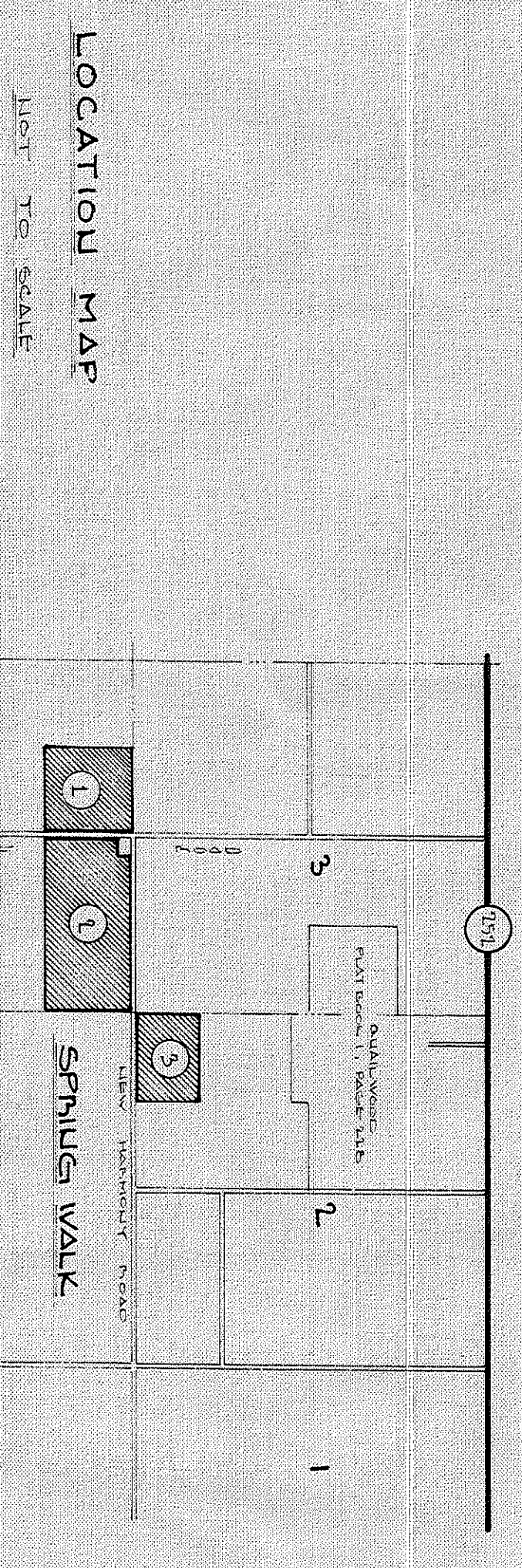

LEGEND AND NOTES

- DENOTES PERMANENT CONTROL POINT (P.C.P.)
- DENOTES PERMANENT REFERENCE MONUMENT (P.R.M.)
- 1) CLOSURE EXCEEDS 1:20000
- 2) BEARINGS BASED ON THE NORTH LINE OF SECTION 10.
- 3) FOR SECTION BREAKDOWNS SEE JOB FILE NO. 297-91
- 4) CONCRETE MONUMENTS SET ON ALL LOT CORNERS.
- 5) PROPERTY LIES WITHIN AGRICULTURE ONE CLASSIFICATION, ONE DWELLING UNIT PER FIVE ACRES

SURVEYOR'S CERTIFICATE:

I HEREBY CERTIFY THAT THIS IS A TRUE AND CORRECT REPRESENTATION OF THE LANDS SURVEYED AND SHOWN HEREON, MADE BY ME, M.S. DEBAMANN, REGISTERED SURVEYOR, PROFESSIONAL NO. 12345, IN SUWANNEE COUNTY, FLORIDA, AND THAT THE SURVEY DATA SHOWN COMPILES WITH THE REQUIREMENTS OF CHAPTER 477, FLORIDA STATUTES AND THAT THE PROPERTY AS PLATTED DOES NOT FALL WITHIN A FLOOD HAZARD AREA AS PER THE FLOOD INSURANCE RATE MAP OF THE FEDERAL EMERGENCY MANAGEMENT AGENCY PANEL NO. 190 & 200 EXCEPT AS SHOWN.

BUILDING PERMIT NOTE

A BUILDING PERMIT FOR THE CONSTRUCTION OR LOCATION OF ANY RESIDENTIAL BUILDING OR STRUCTURE SHALL NOT BE ISSUED FOR LESS THAN ONE ENTIRE LOT AS DEPICTED ON THIS SUBDIVISION PLAT, EXCEPT AS OTHERWISE PROVIDED BY LAW.

CERTIFICATE OF CLERK:

I HEREBY CERTIFY THAT THE FOREGOING PLAT, HAVING BEEN DULY APPROVED BY THE BOARD OF COUNTY COMMISSIONERS OF SUWANNEE COUNTY, FLORIDA WAS ACCEPTED AND FILED FOR RECORD THIS 21st DAY OF November, A.D. 1991, IN PLAT BOOK 1, PAGE 405, OF THE PUBLIC RECORDS OF SAID SUWANNEE COUNTY, FLORIDA.

ADOPTION AND DEDICATION:

KNOWN ALL MEN BY THESE PRESENTS THAT JOSEPH T. CLAYTON AS VICE PRESIDENT OF ENTERPRISE CORPORATION, GULF ATLANTIC, A DELAWARE CORPORATION, REGISTERED TO DO BE SURVEYED, THE PLAT AND ROAD DESCRIBED TO BE KNOWN AS SPRINTS WALK AND THAT THE ROAD AND EASEMENTS ARE HEREBY DEDICATED TO THE PERPETUAL USE OF THE PUBLIC FOR USES AND PURPOSES HERON STATED.

JOSEPH T. CLAYTON
VICE PRESIDENT
WITNESS: Annette Bloom
WITNESS: J. Sherman Fin

STATE OF FLORIDA, COUNTY OF SUWANNEE.

I HEREBY CERTIFY THAT ON THIS 21st DAY OF November, A.D. 1991, BEFORE ME PERSONALTY APPEARED JOSEPH T. CLAYTON AS VICE PRESIDENT OF PATREN CORPORATION GULF ATLANTIC, A DELAWARE CORPORATION AS OWNER TO ME KNOWN TO BE THE IDEAL DESCRIBED IN AND WHO EXECUTED THE FOREGOING DEDICATION AND THEY ACKNOWLEDGE EXECUTION THEREOF.

THIS 21st DAY OF November, A.D. 1991.
Timothy Bruce Bloom
NOTARY PUBLIC, STATE OF FLORIDA
MY COMMISSION EXPIRES: 2001

DEDICATION FOR MORTGAGEE:

THIS IS TO CERTIFY THAT FIRST FEDERAL SAVINGS BANK OF FLORIDA, A CORPORATION UNDER THE LAWS OF THE UNITED STATES OF AMERICA, DOING BUSINESS AS A MORTGAGEE OF THE LANDS DESCRIBED IN THE FOREGOING DESCRIPTION DO HEREBY JOIN IN AND MAKE THEMSELVES A PARTY OF THE DEDICATION OF SAID LANDS AND PLAT KNOWN AS SPRINTS WALK AND THE EASEMENTS FOR THE USES AND PURPOSES HERON EXPRESSED AND THE EASEMENTS ARE HEREBY DEDICATED TO THE PERPETUAL USE OF THE PUBLIC. IN WITNESS WHEREOF, FIRST FEDERAL SAVINGS BANK OF FLORIDA, HAS CAUSED THIS HERON TO BE SIGNED, BY ITS PRESIDENT, KEITH C. LEIBERFIED, AND ITS ASSISTANT SECRETARY, JORGE JOHNSON, BY AND WITH THE AUTHORITY OF ITS BOARD OF DIRECTORS, KEITH C. LEIBERFIED, CORPORATE SEAL APPLIED THIS 21st DAY OF December, A.D. 1991.

KEITH C. LEIBERFIED WITNESS: Keith C. Leibfried
JORGE JOHNSON WITNESS: Jorge Johnson

STATE OF FLORIDA, COUNTY OF SUWANNEE.

I HEREBY CERTIFY THAT ON THIS DAY PERSONALLY APPEARED BEFORE ME, ON OFFICER DULY AUTHORIZED TO ADMINISTER OATHS AND TAKE ACKNOWLEDGMENTS, KEITH C. LEIBERFIED, PRESIDENT, AND JORGE JOHNSON, ASSISTANT SECRETARY, OF FIRST FEDERAL SAVINGS BANK OF FLORIDA, TO ME WELL KNOWN TO BE THE DEEDONS AND EXECUTED THE SAME FREELY AND VOLUNTARILY AS THE ACT AND DEED ON SAID CORPORATION WITH THE OFFICIAL SEAL OF SAID CORPORATION APPLIED THEREON.

WITNESS MY HAND AND SEAL AT LIVE OAK, STATE OF FLORIDA, THIS 21st DAY OF December, A.D. 1991.
Notary Public, State of Florida
MY COMMISSION EXPIRES: 11/11/2001

APPROVED BY BOARD OF COUNTY COMMISSIONERS, SUWANNEE COUNTY, FLORIDA:

SIGNED: _____ CHAIRMAN
DATE: _____
ATTEST: _____ CLERK