

FOXBORO 1ST ADDITION

SITUATED IN THE NORTHWEST 1/4 OF THE SOUTHWEST 1/4 AND THE SOUTHWEST 1/4 OF SAID SECTION 28, TOWNSHIP 2 SOUTH, RANGE 13 EAST, SUIWANNE COUNTY, FLORIDA.

PLAT BOOK I PAGE 403

DESCRIPTION.

SECTION 28, TOWNSHIP 2 SOUTH, RANGE 13 EAST, SUIWANNE COUNTY, FLORIDA. BEING MORE PARTICULARLY DESCRIBED AS FOLLOWS: FOR POINT OF BEGINNING CORNER OF SAID SOUTH 1/2 OF THE NORTHWEST 1/4 OF THE SOUTHWEST 1/4 OF SAID SECTION 28, TOWNSHIP 2 SOUTH, RANGE 13 EAST, SUIWANNE COUNTY, FLORIDA, BEING THE SOUTHWEST CORNER OF SAID SECTION 28, TOWNSHIP 2 SOUTH, RANGE 13 EAST, SUIWANNE COUNTY, FLORIDA.

ADOPTION AND DEDICATION.

KNOWN ALL MEN BY THESE PRESENTS, THAT THE ABOVE DESCRIBED TRACT OF LAND HAS BEEN SET ASIDE FOR THE PURPOSES OF A PUBLIC HIGHWAY AND DEDICATED TO THE PUBLIC USE OF THE PUBLIC FOR USE AS A HIGHWAY, HEREBY STATED.

WITNESS MY HAND AND SEAL AT THE CITY OF SUWANNEE, FLORIDA, THIS 21st DAY OF NOVEMBER, A.D. 1990.

STATE OF FLORIDA, COUNTY OF SUWANNEE.

I HEREBY CERTIFY THAT ON THIS 21st DAY OF NOVEMBER, 1990, BEFORE ME, A NOTARY PUBLIC, STATE OF FLORIDA, PERSONALLY APPEARED THE FOLLOWING INDIVIDUALS WHOSE NAMES AND RESIDENCES ARE SET FORTH IN THE ABOVE INSTRUMENT, AND WHO EXECUTED THE FOREGOING INSTRUMENT AND THEIR MANUSCRIPT EXECUTION THEREOF.

APPROVED BY BOARD OF COUNTY COMMISSIONERS, SUWANNEE COUNTY, FLORIDA.

SIGNED: DATE: 11/20/90

CERTIFICATE OF CLERK.

I HEREBY CERTIFY THAT THE FOREGOING PLAT HAVING BEEN SUBMITTED TO THE BOARD OF COUNTY COMMISSIONERS OF SUWANNEE COUNTY, FLORIDA, AND BEING IN ACCORDANCE WITH THE PROVISIONS OF CHAPTER 218, F.S., AND THE PUBLIC RECORDS OF SAID SUWANNEE COUNTY, FLORIDA.

SURVEYOR'S CERTIFICATE.

HEREBY CERTIFY THAT THIS IS A TRUE AND CORRECT REPRESENTATION OF THE LAND SURVEYED AND SHOWN HEREON. I AM A LICENSED SURVEYOR IN THE STATE OF FLORIDA.

J. SHERMAN FRIER & ASSOCIATES, LAND SURVEYORS, 914 NORTH OGDEN AVE., P.O. BOX 280, ALLE OAK, FLORIDA 32906.

CURVE TABLE. Table with columns: CHAINAGE, BEARING, AND DISTANCE. It lists data for curves 1 through 10.

GRAPHIC SCALE. SCALE IN FEET. 0 to 200 feet.

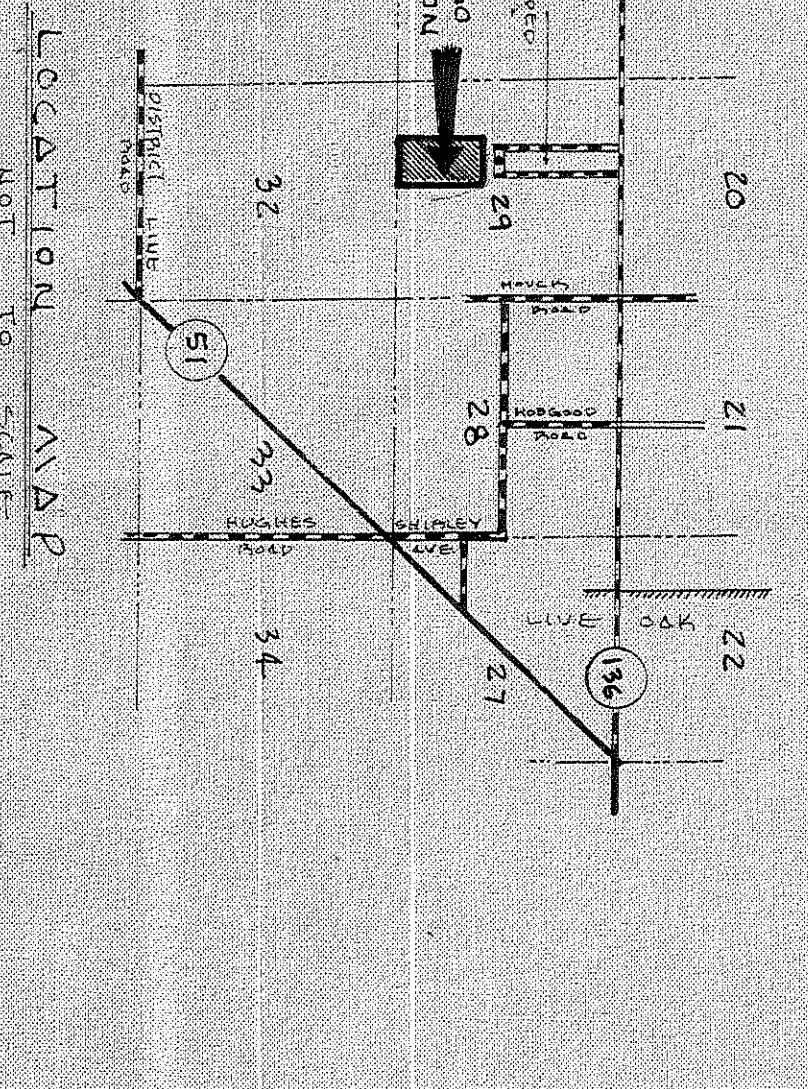

GRAPHIC SCALE. SCALE IN FEET. 0 to 200 feet.

NOTICE. THESE AND ANY ADDITIONAL RESTRICTIONS THAT ARE NOT RECORDED OF THIS COUNTY.

NOTES: 20. UTILITY EASEMENTS AS SHOWN. EASEMENTS FOR THE CONSTRUCTION AND MAINTENANCE OF TELEVISION AND CABLE TELEVISION SERVICES.